

100
0 10
Millimetres

DO NOT SCALE

GENERAL ARRANGEMENT KEY

- Red Line Boundary - Client ownership
- Proposed Contours for Drainage Features
- Permeable paving - vehicular permeable paving sub base to engineer's specification
- Vehicular Tarmac Sub-base to engineer's specification
- Concrete pad foundations to security lodge & generators to engineer's specification
- Blister Warning Paving to Road Crossings
- Bollards - PAS 68 to parking bays Stainless steel
- Bollards - Static Stainless steel
- Bollards - Removable Stainless steel
- Fixed benches Timber and stainless steel
- Stainless steel Sheffield cycle stands building entrance
- Boulders for SuDS inlet erosion control - rough sizes to be cut and detailed at later design stage but approximately 300-500mm diameter.
- Thermoplastic Road Markings
- Double leaf gate to main site entrance, exit & maintenance access - 4m high, stainless steel. Colour - Black.
- Proposed 4m high Secure Fence Colour - black
- Proposed 1.8m high Fence to eastern Site Boundary Colour - black
- Proposed 1.2m high post and rail fence
- Existing Trees Retained*
- Proposed Trees
- Root Protection Areas
- Proposed Native Shrub Planting
- Proposed Rain Garden Planting
- Proposed Swale Planting
- Proposed Species Rich Grassland
- Proposed Bulb Planting
- Existing Levels
- Proposed Levels

*Locations based on Arboricultural Survey Drawing number: 5197838-ATK-BHM-ARB001

SAFETY, HEALTH AND ENVIRONMENTAL INFORMATION

In addition to the hazards/risks normally associated with the types of work detailed on this drawing, note the following:

- CONSTRUCTION
- MAINTENANCE/CLEANING
- DECOMMISSIONING/DEMOLITION

It is assumed that all works will be carried out by a competent contractor working, where appropriate, to an approved method statement

To be read in conjunction with drawings:
DC3-ATK-XX-XX-DR-L-9300 - Softworks
DC3-ATK-XX-XX-DR-L-9450 - Site Sections
DC3-ATK-XX-XX-DR-L-9500 - Fencing Detail

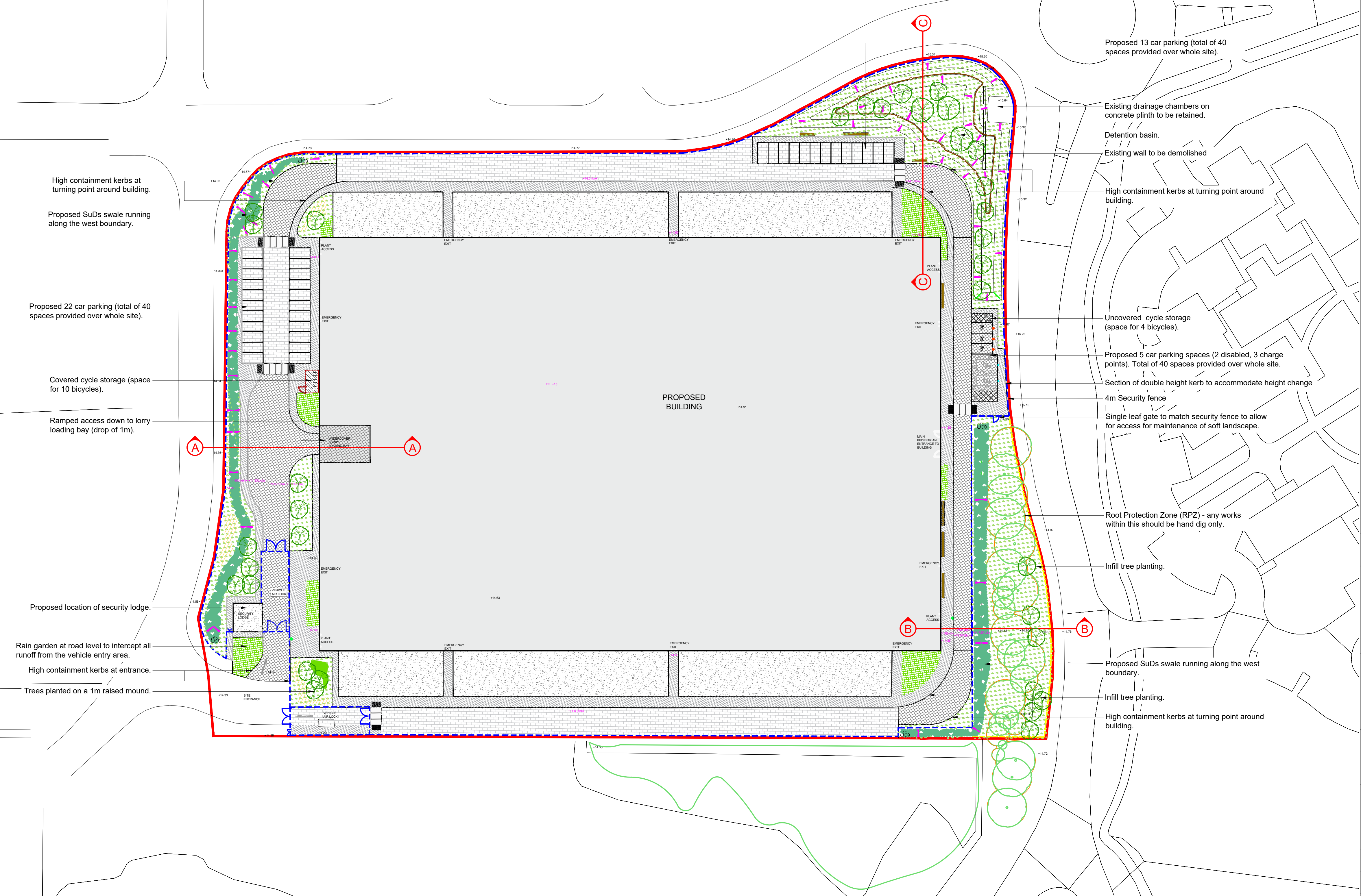

P01	23/10/20	Stage 2 For Planning		CMS	EW	WR
Rev.	Date	Description		By	Chkd	App'd

FOR INFORMATION SO

ATKINS 500 Park Avenue
Aztec West
Almondsbury
Bristol
BS32 4RZ
Tel: +44 (0)1454 662000
Fax: +44 (0)1454 663333
Copyright © Atkins Limited (2013) www.atkinsglobal.com

Client
NEXT GENERATION DATA

Project Title
Data Centre Three

Drawing Title
LANDSCAPE GENERAL ARRANGEMENT PLAN

Scale	Designed	Drawn	Checked	Authorised
1:500	AB	CMS	EW	WR
Original Size	Date	Date	Date	Date
A1	23/10/2020	23/10/2020	23/10/2020	23/10/2020
Drawing Number	Revision			
DC3-ATK-XX-XX-DR-L-9100				P01